

# miniK 10

The easy lock in every aspect

● cabinets    ● lockers    ● boxes

## INSTALLATION

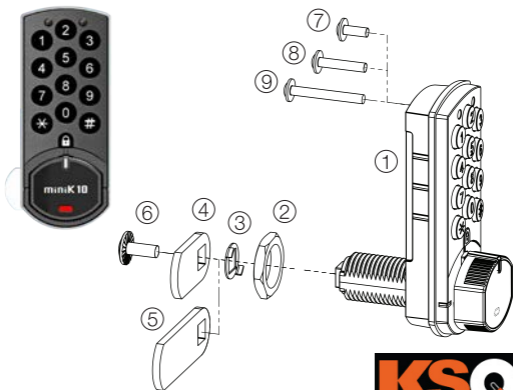

# Installation Overview

1. miniK10
2. M16x1,5mm Cylinder Nut
3. Stop Cam
4. Cam 22mm Axle (Optional)
5. Cam 38mm Axle
6. M4x10mm Cam Screw
- 7-9. Mounting Screws

Locking Position  
(Be sure before mounting).



Rotate Right  
(90°) to Open

Cover thickness	Screw size
⑦ 0 - 5 mm covers	8 mm
⑧ 10 - 12 mm covers	16 mm
⑨ 16 - 18 mm covers	24 mm

Do not use longer screw.  
It may cause damage!

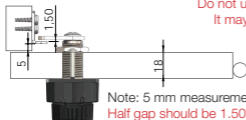

Note: 5 mm measurement is for 18 mm..!  
Half gap should be 1.50 mm

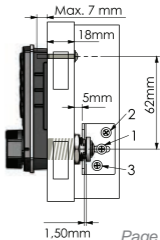
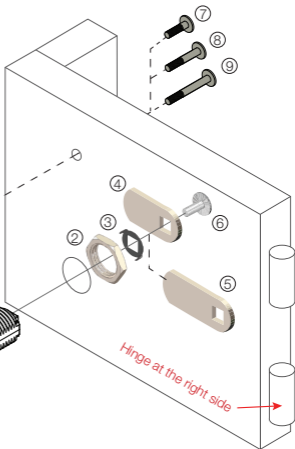

## Mounting on Left & Right Door

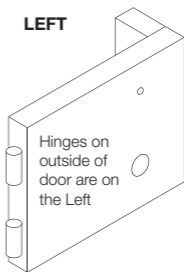
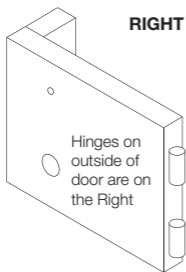

Peg on stop cam is on the right side for right doors

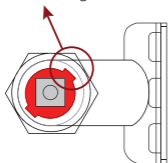

### Back View

Knob, rotates to the right to open lock

Peg on stop cam is on the left side for left doors

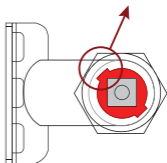

### Back View

Knob, rotates to the left to open lock



View of the lock in locked position

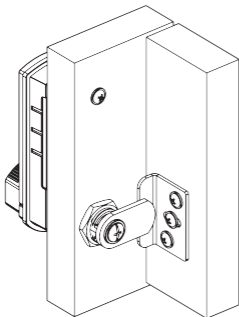

Surface Mounting

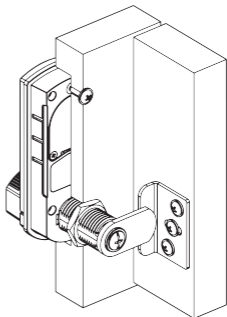

Semi-Flush Mounting



\* Assembly set is not.

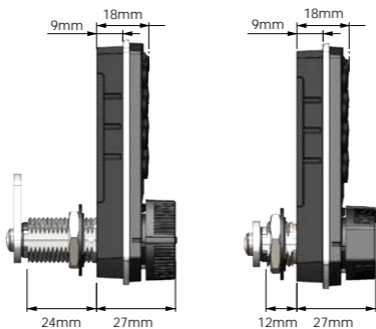

# Mounting Template

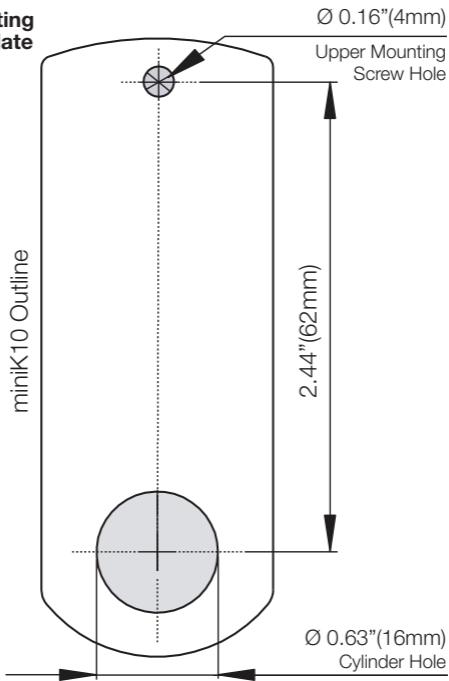

## JOINT ERECT LOCK ASSEMBLY MEASUREMENTS

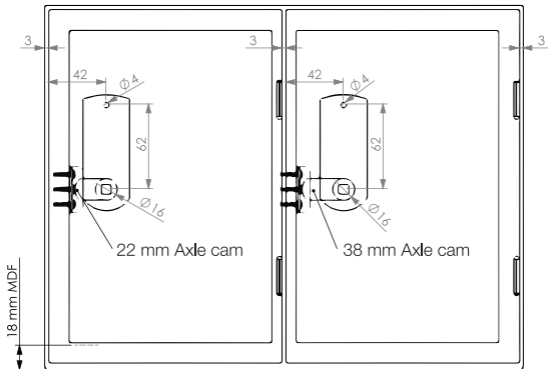

## RECESSED COVER ASSEMBLY MEASUREMENTS

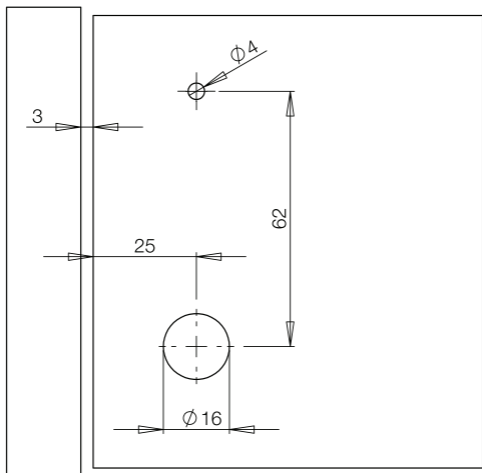



## OVERLAPPING / EXTERNAL COVER ASSEMBLY MEASUREMENTS

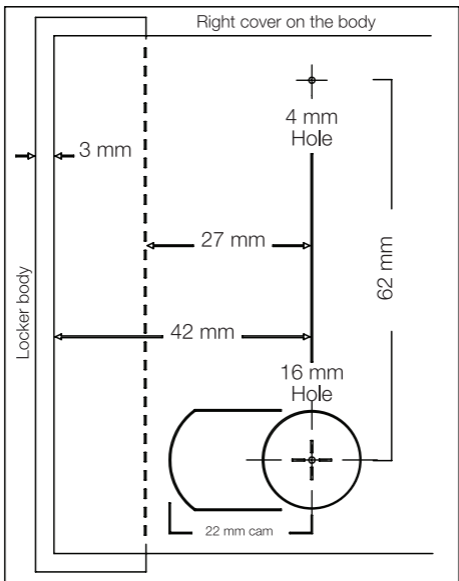



**NOTE:** Read instructions, set combination and test lock BEFORE installing!

### Replacing existing lock:

1. Place mounting template centered on existing hole and mark upper mounting screw hole.
2. Drill mounting screw hole.
3. Install lock using adaptor if necessary.
4. Thread nut on cylinder.
5. Install mounting screw
6. Tighten both nut and mounting screw.
7. Test operation of lock

### New Install:

1. Place mounting template on door and mark upper mounting screw hole and lower cylinder hole
2. Drill mounting screw hole and cylinder holes.
3. Continue steps 4-7 above



**NOTE:** Before drilling holes, make sure miniK10 is positioned with proper clearance for cam to work.



If you are going to install the lock cam in the locked position, make sure that the handle is in the **locked position**.



**LOCKED  
POSITION**

If you are going to install the lock cam in the unlocked position, make sure that the handle is in the **unlocked position**.



**UNLOCKED  
POSITION**



## WARNINGS FOR MOUNTING:

1. Pull the transparent “Remove to Start” tag coming out of battery cap at the back of the lock and activate the lock.
2. Read the user manual and apply password change and opening/closing operations several times before the mounting of the lock.
3. Before mounting of the lock, switch lock handle to closing position.
4. Make sure that there is no friction in the cabinet lids. If there is a friction in the cabinet lids, make the hinge adjustments and make the cabinet lid operable.
5. Do not forget to place Stop Cam depending on the condition of the right or left lid of your cabinet.
6. Do not over-tighten nuts or screws. The maximum torque on the cylinder screw is 2 Nm.
7. Ensure that there is no friction between strike plate and the cam.
8. Finally check the mounting screws, tighten the loose screws.
9. When placing the existing locks into place, if the cylinder hole is big, use the adapter and do not over tighten the cylinder nut. (max. 2 Nm).
10. Check the cabinet lid hinge adjustment at least once a year. Tighten loose screws.



# miniK 10

The easy lock in every aspect

Schools



Hospitals



Spa  
and  
Baths



In  
Mailboxes



Sports Halls



Staff Lockers



[www.minik10.com.au](http://www.minik10.com.au)

Neaves Investment Group Pty Ltd T/a Keywatch Systems Qld.  
Suite 26/42 Bundall Road Bundall QLD 4217

+61 (07) 55 26 27 26

[sales@ksq.com.au](mailto:sales@ksq.com.au)

