

# miniK 10pc

## electronic cabinet lock

● cabinets    ● boxes    ● drawers

### OPERATING MANUAL



Please read this  
manual before using  
the **miniK10pc**

## INDEX

Introduction.....	3
Description.....	4
Initial Setup.....	4
Assign Master Card.....	4
Locker Mode Operation with Card To Lock/Unlock.....	4
• To Lock.....	4
• To Unlock.....	5
Personal Operation with Card To Lock/Unlock.....	5
• To Unlock.....	5
• To Lock.....	5
Change Operation to Personal Mode (Assign Personal Card) .....	6
Change Operation to Locker Mode .....	6
General Warnings.....	7
Cam.....	7
Light and Audio Warnings.....	8
Technical Specifications .....	8
K10pc Card Specifications .....	8
Battery Replacement.....	9
To be Considered After Battery Replacement .....	9
Battery Failure Override .....	9
When Using The Lock .....	9
When Storage The Lock.....	9
Maintenance.....	9
Limited Warranty .....	10
Liability Limits .....	10
Quick Info .....	11

## INTRODUCTION

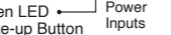
- 

The diagram shows the internal components of the Z-Wave Lock. A legend indicates that a solid line represents an 'External Power Input' and a dashed line represents a 'Wireless Signal'. The components are numbered 1 through 19.

  - 1. Red LED
  - 2. Green LED
  - 3. Wake-up Button
  - 4. Lock Body
  - 5. Closing Position
  - 6. Knob Indicator
  - 7. Opening Position
  - 8. Knob
  - 9. Mounting Screw
  - 10. Lock Body
  - 11. Battery Cover
  - 12. Battery Cover Screw
  - 13. ID Label
  - 14. Hand Knob Frame
  - 15. Cam
  - 16. Cam Screw
  - 17. Mounting Nut, R/L Stop Cam
  - 18. Open/Closed Indicator
  - 19. Card Compatibility indicator

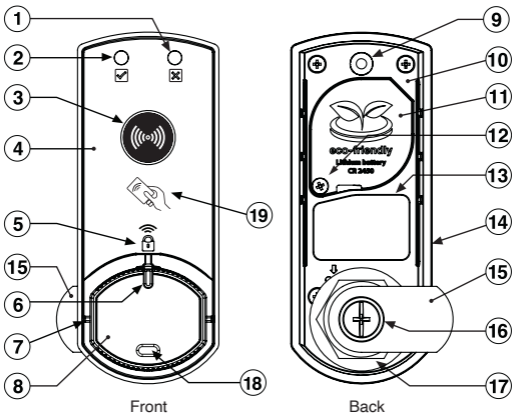

## DESCRIPTION:

**miniK10pc** it is an electronic combination cabinet lock with features such as easy application on right/left cabinet doors, longer battery life with very low energy consumption, high reliability and working with contactless cards.



## INITIAL SETUP:

### • Assign Master Card:

- 1- Press the button twice, two tone beep is heard repeatedly.
- 2- And then present the **Master Card** over the button until one tone beep is heard and green led blinks.



**This step is valid if there is no assigned Master Card before.**

### • Locker Mode Operation with Card

#### • To Lock:

- 1- Press the button for wake the lock up. Only one beep is heard.
- 2- Present **User Card or Master Card** over the button in 5 seconds.
- 3- Turn the knob to the locked position.



• **To Unlock:**

- 1- Press the button for wake the lock up. Only one beep is heard
- 2- Present **the card that locked the cabinet or Master Card** over the button in 5 seconds.
- 3- Turn the knob to the unlocked position.



**Personal Operation with Card**

• **To Unlock:**

- 1- Press the button for wake the lock up.
- 2- Present any assigned **User Card or Master Card** in 5 seconds.
- 3- Turn the knob to the unlocked position.



• **To Lock:**

- 1- Turn the knob to the locked position.



## Change Operation to Personal Mode (Assign Personal Card)

- 1- Press the button twice.
- 2- Present the **Master Card** over the button until one tone beep is heard and green led blinks.
- 3- Press the button once and observe the green and red led blinks.
- 4- Present the **User Card** over the button. Lock operation mode is changed to personal mode.



## Change Operation to Locker Mode

- 1- Press the button twice.
- 2- And then present the **Master Card** over the button until one tone beep is heard and green led blinks.
- 3- Press the button once and observe the green and red led blinks.
- 4- Present the **Master Card** over the button. Lock operation mode is changed to Locker mode.



## GENERAL WARNINGS:

- Read manual before using lock.
- Periodically check nuts and screws to be tightened.
- Do not over-tighten nuts or screws. Do not use an electric screw gun during installation unless equipped with a torque adjuster. The maximum torque on the cylinder screw is 2Nm.
- Not possible for front side of lock to be opened by breaking or trying to force open lock.
- Use CR2450 3.0V Lithium batteries.
- The lock battery can be replaced with a CR 2450 battery with a min.600mA capacity.
- It should not be preferred that the production date of the new battery to be installed is more than 1 year.



## CAM:

- Cam are included
- Cam can be placed at increments of 90 degrees
- The Stop Cam (#3) in installation instructions can be positioned for turning the cam clockwise or counter-clockwise



7/8" Straight Cam 38mm  
(It is recommended)





## LIGHT AND AUDIO WARNINGS:

<b>Card is accepted</b>	Green LED blinks with audio warnings.
<b>Wrong card</b>	Red LED blinks with 4 repeated audio warnings.

## TECHNICAL SPECIFICATIONS:

Dimension (WxHxD)	34 x 85 x 27 mm (1.34 x 3.35 x 1.06in)
Weight	70,4 g (2.48 oz) (excluding cam and mounting)
Key Pad	Silicone button with metal dome
Operating Temperature (*)	+10 / +50 °C (50 - 122 °F)
Storage Temperature	+0 / +30 °C (32 - 86 °F)
Relative Humidity	20% - 80% Rh (non-condensing)
Replaceable Battery	3V Lithium CR2450
Battery Life (**)	Up to 2 years with daily 10 opening

 **ATTENTION:** (\*) Battery life may vary in accordance with battery brand, programming parameters and environmental conditions of the product is used.

 **ATTENTION:** (\*\*) Battery life may vary in accordance with battery brand, programming parameters and environmental conditions of the product is used.

 **ATTENTION:** miniK10pc is made for only interior usage.

## K10pc CARD SPECIFICATIONS:

Transponder Chip	EM4100 Compatible
Frequency	125Khz
ID Size	64 bit Read Only
Encoding	Manchester Encoding

## **BATTERY REPLACEMENT:**

The lock operates using a 3V lithium coin cell CR2450 battery located on back side of device. Remove the battery cover on the back of the lock and replace it with new battery.

## **TO BE CONSIDERED AFTER BATTERY REPLACEMENT:**



- As soon as the batteries are replaced, they should be packaged in a way to prevent short circuit and sent to battery collection centres. Batteries should not be disposed of in the garbage or in nature.
- Waste batteries should not be exposed to moisture, liquids (including water) and heat.
- To prevent risks that may arise from collected waste batteries, they should be temporarily stored in insulated containers or cabinets.

## **BATTERY FAILURE OVERRIDE:** *(If the lock installed on to locker)*

- Remove the caps from the holes of Red and Green leds, leds insert the pins of the miniK10 Power Adapter into these holes and press.
- When the lock wakes up, enter your password and unlock it.

## **WHEN USING THE LOCK:**

- The battery CR2450 is NOT rechargeable and should NOT be tentatively charged.
- Do not wash the lock.
- Do not allow water to get inside the lock.

## **WHEN STORAGE THE LOCK:**

- Do not open, destroy nor incinerate the battery CR2450.
- Do not crush, pierce, or short "+" and "-" battery terminals with conductive i.e. metal goods, screws.
- Do not directly heat the battery and not throw it into fire.

## **MAINTENANCE:**

- Clean front of lock with a mild damp cloth with detergent if needed.
- Use only Ethanol (Ethyl Alcohol) for disinfecting.
- Do not use any hard or scratching cleanser.
- Do not clean with chemical materials that melt plastic (thinner, acetone, etc.)
- Be careful not to spill water on lock.



## **ATTENTION!**

In case of any failure, inform the vendor in writing of the detailed description of the failure. In case of any intervention in the device, such as attempting to repair the device, the device gets **OUT OF WARRANTY**.

### **LIMITED WARRANTY:**

VMS Elektronik A.S. offers a one year limited warranty all products to be free from manufacturing defects in materials and workmanship. This warranty does not cover the battery, lost combinations or damages caused by improper mounting, improper or unreasonable use.

### **LIABILITY LIMITS:**

This is a limited warranty and is in lieu of all other warranties (including the implied warranties of merchantability and fitness for use) and under no circumstances shall VMS Elektronik A.S. be liable for any incidental or consequential damages or losses.

### **Thank you**



Congratulations for making this eco-friendly choice! By purchasing a miniK10pc, you will prevent additional batteries going to the landfills over the up to 2 years. This period may be reduced according to battery performance, environmental conditions and frequency of use.

## LOCKING / UNLOCKING WITH USER CARD



## LOCKING / UNLOCKING WITH MASTER CARD



# miniK 10



In all areas of life



**School / Dormitories**



**Hospitals**



**Offices**



**Gym's / Spa's**



**Malls / Stores**



**Hotels / Restaurants**



**Staff Lockers**



**Mailboxes**

5/89 Derby St, Silverwater NSW 2128

1300 311 556

[www.ksq.com.au](http://www.ksq.com.au)

[sales@ksq.com.au](mailto:sales@ksq.com.au)



**MADE IN TÜRKİYE**